

**ESSENTIAL DT (CIRCUIT CONSTRUCTION)
VOCABULARY**

Woven	Braiding or intertwining threads or fibres together.
Non-woven	Using short and long fibres that are put together by chemical, machinery, heat or solvent (something that dissolves an item) treatment.
Stitch	Sewing techniques used to join fabrics together to make a product or adds a decorative design to the product.
Fibres	Long, thin strands of material made by plants, animals or humans. Fibres can be used to make many useful products. Some fibres are natural or artificial.
Needle	A tool that is used to push or pull a thread through a small hole.
Thread	Length of twisted fibres made from either cotton, silk or other materials. These can be coloured strands and put through a needle to create a stitch.
Seam	A stitch that joins pieces of fabrics together.
Seam allowance	The area from the stitching line to the edge of the fabric.



**MAKING LINKS TO PREVIOUS LEARNING
GOLDEN VOCABULARY**

Weaving	When a number of fibres or threads are crossed over each other using the 'warp and weft' technique to form a fabric or cloth.
----------------	---

**Yr4 KNOWLEDGE ORGANISER
Design & Technology – Textiles**

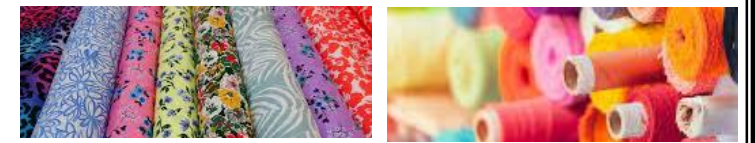

Materials

Threading tips!

Method 1

Use scissors to trim the end of your thread because a frayed end will be difficult to thread through the needle.



Method 2

Use a needle threader tool. Slide the loop on the end of the tool through the eye of the needle. Then, push the thread through this loop.

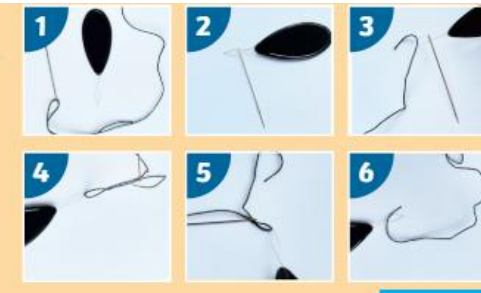

Now, pull the needle threader tool backwards away from the eye of the needle. The tool will pull the thread through the eye of the needle as this happens.

Calico material



Felt material



A **running stitch** is also known as a straight stitch that is used to attach pieces of fabrics together. The stitch follows a simple line of straight stitches with the needle going up through a hole and then down through the hole. The up and down steps are repeated until the stitch is no longer required. A knot to the thread is tied before removing the thread and needle from the fabric.



A **blanket stitch** is a decorative seam stitch that creates a beautiful pattern at the edge of the fabric and adds extra detail to the seam of the sewing creation.

Sewing Safely

Here are some top tips to help you sew safely.

- Keep pins in a container with a lid or use a pin cushion.
- Use a magnet to pick up any pins that drop.
- Always direct sharp tools away from the body when you work.
- Work at a table with plenty of space.